

KVT 3.140

Ersatzteilliste
 Spare parts list
 Liste de pièces de rechange
 Listino pezzi di ricambio
 Lista de piezas de recambio
 Lista de peças sobresselentes
 Reserveonderdelenlijst
 Reservdelistsite
 Reservdelistsita

Reservdelistsite
 Varaosaluettelo
 Wykaz części zamiennych
 Seznam náhradních dílů
 Tartalékalkatrész lista
 Κατάλογος ανταλλακτικών
 Yedek parça listesi
 Перечень запасных частей
 备用零件目录
 スペアパーツリスト

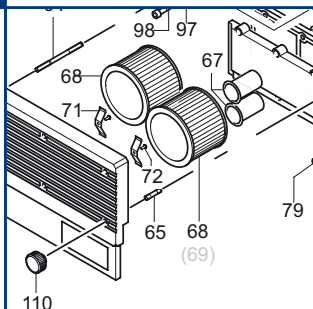

SERVICE

BECKER
D-42279 Wuppertal
www.becker-international.com

year

No **D** **Index Variante**

type **KVT 3.140-XX**

frequency Hz

speed min⁻¹

power required kW

inlet capacity m³/h

pressure + mbar

vacuum - mbar

Made in Germany

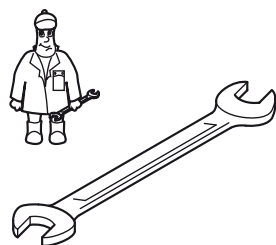

| Pos. | Menge ²⁾ Quantity Quantité Quantità Cantidad | Bestell-Nr. Ident No. No. Identification No. Identificazione No. de pedido | Bezeichnung Description Designation Designazione Descripción |
|----------|---|--|--|
| □ | 1 | 549000 21300 | Dichtungssatz, Complete set of seals, Jeu de joints, Kit di guarnizioni, Junta Completa |
| 11 11 | SATZ/KIT | 901334 00004 901381 00004 | Schieber, Rotor Vane, Palette, Empujador " KVT 3.140/6 |
| 68 | 2 | 909507 00000 | Filterpatrone, Filter cartridge, Cartouche Filtrante, Cartuccia filtro, Cartucho de filtro |
| 68 | 1 | 909507 00000 | " KVT 3.140/6 |
| 69 | 1 | 909587 00000 | " KVT 3.140/6 - Polyester |
| 91 | 1 | 909514 00000 | Filterpatrone, Filter cartridge, Cartouche Filtrante, Cartuccia filtro, Cartucho de filtro |

²⁾ erforderliche Bestellmenge / necessary order quantity / quantité nécessaire / quantità di ordinazione necessari / cantidad necesario

Wartung
Maintenance
Entretien
Manutenzione
Mantenimiento



SERVICE

www.becker-international.com

Sales and service network

KVT 3.140 Standard



Variante



KVT 3.140/XX

①

US-motor

②-④

- /6, /6-54, /6-59
- Korrosionsschutz
- corrosion protection
- protection contre la corrosion
- protezione anti-corrosione
- protección contra la corrosión

⑤

/0-54

- Kühlung
- refrigeration
- réfrigération
- refrigerazione
- refrigeración

⑥

/0-400

- mit Frequenzumrichter
- with frequency convertor
- avec convertisseur de fréquence
- con convertitore di frequenza
- con convertidor de frecuencia

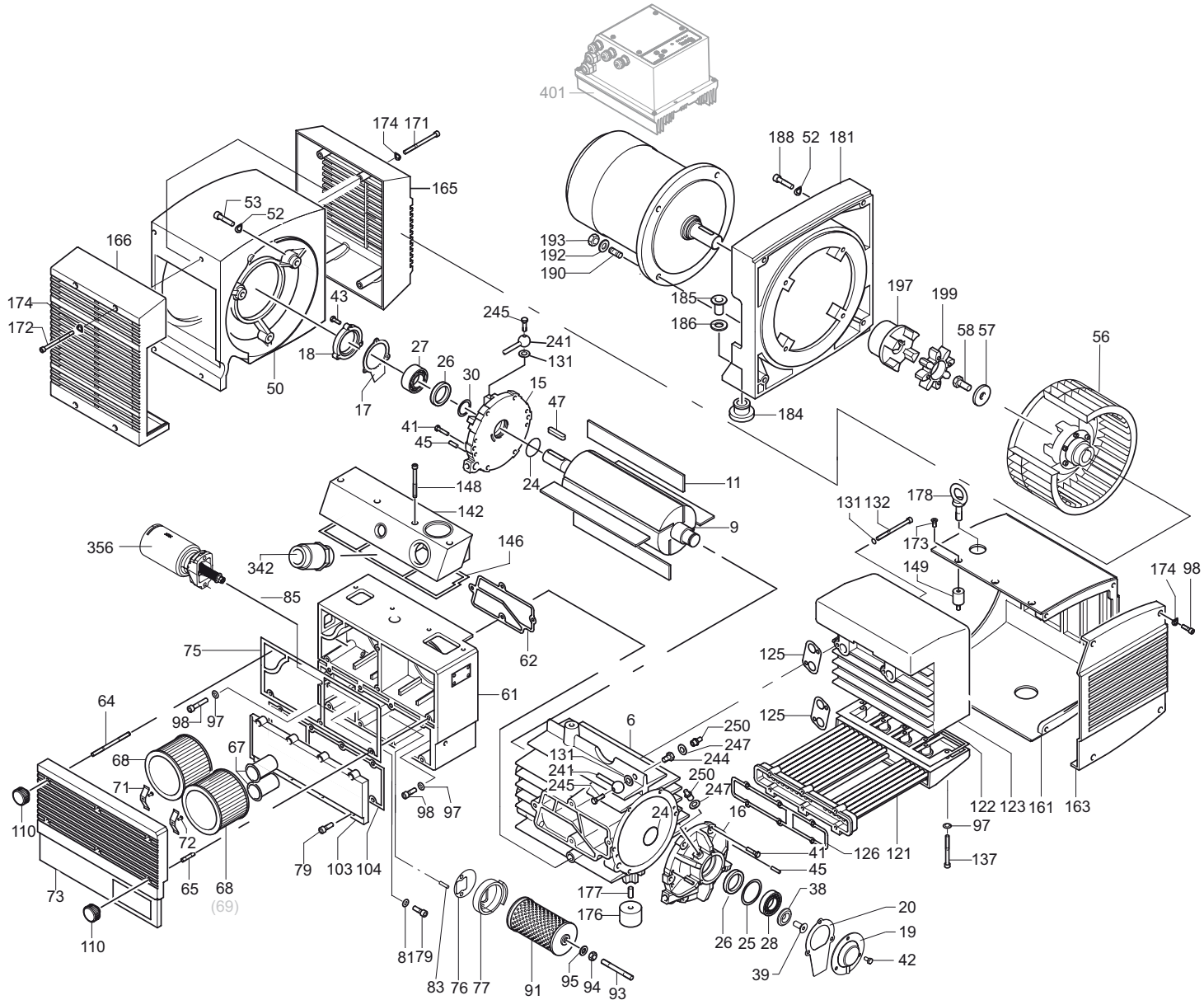

SERVICE ?

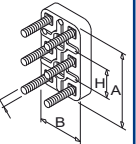
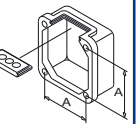
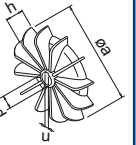
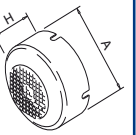
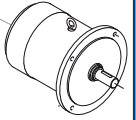



| D INDEX | Pos. | Bestell Nr. | Beschreibung | DE | |
|------------|--------------|--|--------------------------------------|----|--|
| | | | | | |
| KVT 3.140 | □ | 549000 21300 | DICHTUNGSSATZ ¹⁾ | | |
| | 6 | 000101 21300 | GEHÄUSE | | |
| | 9 | 020004 21300 | KOLBEN | | |
| | 11 | 901334 00004 | SCHIEBER (SATZ) ²⁾ | | |
| | 15 | 000801 21300 | SEITENDECKEL LINKS | | |
| | 16 | 000701 21300 | SEITENDECKEL RECHTS | | |
| | 17 | 025512 21300 | DICHTUNG | | |
| | 18 | 001101 21300 | LAGERDECKEL | | |
| | 19 | 001006 21300 | LAGERDECKEL | | |
| | 20 | 025513 21300 | DICHTUNG | | |
| | 24 | 911305 00000 | DICHTUNGSSCHLAUCH | | |
| | 25 | 917159 00000 | AUSGLEICHSCHLEIBE | | |
| | 26 | 906544 00000 | WELLENDICHRING | | |
| 27 | 906621 00000 | WÄLZLAGER 3206/C3 | | | |
| 28 | 906664 00000 | WÄLZLAGER NU 206/ZS | | | |
| 30 | 511400 10400 | SATZ DISTANZSCHEIBEN | | | |
| 38 | 016801 21300 | SPANNSCHEIBE | | | |
| 39 | 949807 00000 | SENKSCHEIBE | | | |
| 41 | 945224 00000 | SECHSKANTSCHRAUBE | | | |
| 42 | 945218 00000 | SECHSKANTSCHRAUBE | | | |
| 43 | 901804 00000 | SECHSKANTSCHRAUBE | | | |
| 45 | 948742 00000 | PASSKERBSTIFT | | | |
| 47 | 947736 00000 | PASSFEDER | | | |
| 50 | 053201 21300 | LATERNE | | | |
| 52 | 950308 00000 | UNTERLEGSCHEIBE | | | |
| 53 | 945331 00000 | INNENSECHSKANTSCHRAUBE | | | |
| 56 | 544501 21300 | KUPPLUNGSHÄLFTE MIT VENTILATOR | | | |
| 57 | 949409 00000 | UNTERLEGSCHEIBE | | | |
| 58 | 945270 00000 | WELLENENDSCHRAUBE | | | |
| 61 | 040102 21300 | FILTERGEHÄUSE | | | |
| 62 | 025501 21300 | DICHTUNG | | | |
| 64 | 951009 00000 | STIFTSCHRAUBE | | | |
| 65 | 951003 00000 | STIFTSCHRAUBE | | | |
| 67 | 964407 00000 | SCHALLDÄMPFERROHR | | | |
| 68 | 909507 00000 | FILTERPATRONE C 1112/2 (2x) ²⁾ | | | |
| 71 | 009000 27000 | ANPRESSFEDER | | | |
| 72 | 948750 00000 | BLINDNIET | | | |
| 73 | 040204 21300 | FILTERDECKEL | | | |
| 75 | 025518 21300 | DICHTUNG | | | |
| 76 | 025516 21100 | DICHTUNG | | | |
| 77 | 022802 21100 | FILTERTRÄGER | | | |
| 79 | 945320 00000 | INNENSECHSKANTSCHRAUBE | | | |
| 81 | 947504 00000 | UNTERLEGSCHEIBE | | | |
| 83 | 952019 00000 | SPANNHÜLSE | | | |
| 91 | 909514 00000 | FILTERPATRONE C 718 (1x) ²⁾ | | | |
| 93 | 903800 70000 | STIFTSCHRAUBE | | | |
| 94 | 947105 00000 | SECHSKANTMUTTER | | | |
| 95 | 949450 00000 | UNTERLEGSCHEIBE | | | |
| 97 | 950304 00000 | UNTERLEGSCHEIBE | | | |
| 98 | 945321 00000 | INNENSECHSKANTSCHRAUBE | | | |
| 103 | 068801 21300 | STAUBABSCHIEDERDECKEL | | | |
| 104 | 025515 21300 | DICHTUNG | | | |
| 110 | 921500 50000 | HANDGRIFF | | | |
| 121 | 560204 21300 | KÜHLER | | | |
| 122 | 025506 21300 | DICHTUNG | | | |
| 123 | 066802 21300 | DRUCKANSCHLUSSKASTEN | | | |
| 125 | 025504 21300 | DICHTUNG | | | |
| 126 | 025514 21300 | DICHTUNG | | | |
| 131 | 948021 00000 | DICHTRING | | | |

| D INDEX | Pos. | Bestell Nr. | Beschreibung | DE | |
|------------|------|--------------|---|----|--|
| | | | | | |
| | 132 | 945374 00000 | INNENSECHSKANTSCHRAUBE | | |
| | 137 | 945322 00000 | INNENSECHSKANTSCHRAUBE | | |
| | 142 | 016605 21300 | ANSCHLUSSLEISTE | | |
| | 146 | 025507 21300 | DICHTUNG | | |
| | 148 | 945364 00000 | INNENSECHSKANTSCHRAUBE | | |
| | 149 | 741310 30000 | GUMMIPUFFER | | |
| | 161 | 918300 21300 | ABDECKHAUBE | | |
| | 163 | 920800 21300 | LUFTLEITHAUBE | | |
| | 165 | 960700 21300 | LÜFTERHAUBE | | |
| | 166 | 960701 21300 | LÜFTERHAUBE | | |
| | 171 | 945371 00000 | INNENSECHSKANTSCHRAUBE | | |
| | 172 | 945372 00000 | INNENSECHSKANTSCHRAUBE | | |
| | 173 | 949806 00000 | SENKSCHEIBE | | |
| | 174 | 951703 00000 | FEDERSCHLEIBE | | |
| | 176 | 741302 00000 | GUMMIPUFFER | | |
| | 177 | 945634 00000 | GEWINDESTIFT | | |
| | 178 | 948802 00000 | RINGSCHRAUBE | | |
| | 181 | 014902 21300 | ZWISCHENFLANSCH | | |
| | 184 | 951916 00000 | KABELTÜLLE | | |
| | 185 | 948772 00000 | ROHRNIETE | | |
| | 186 | 947508 00000 | UNTERLEGSCHEIBE | | |
| | 188 | 945335 00000 | INNENSECHSKANTSCHRAUBE | | |
| | 190 | 951018 00000 | STIFTSCHRAUBE | | |
| | 192 | 947506 00000 | UNTERLEGSCHEIBE | | |
| | 193 | 947106 00000 | SECHSKANTMUTTER | | |
| | 197 | 902108 00000 | KUPPLUNGSHÄLFTE (MOT) | | |
| | 199 | 902210 00000 | KUPPLUNGSSCHLEIBE | | |
| | 241 | 012200 21300 | LEITUNG | | |
| | 244 | 912300 00000 | ANSCHLUSSSCHRAUBE | | |
| | 245 | 009400 19000 | KUGELSTÜCKSCHRAUBE | | |
| | 247 | 948074 00000 | DICHTRING | | |
| | 250 | 949002 00000 | TRICHTERSCHMIERNIPPEL | | |
| | 342 | 736001 99624 | VAKUUMREGULIERVENTIL | | |
| | 356 | 727510 99323 | ABBLASEVENTIL | | |
| | | 743303 00000 | LAGERFETT, AMBLYGON TA15/2 (FETTPRESSE, 50g) | | |

¹⁾ **Dichtungssatz** - 54900021300 - Pos.: 17, 20, 24, 62, 75, 76, 86, 104, 122, 125, 126, 146

²⁾ erforderliche Bestellmenge / Wartung

| D INDEX | Pos. | Ident No. | Description |  |
|------------------|------|--------------|---|---|
| KVT 3.140 | □ | 549000 21300 | SET OF SEALS ¹⁾ | |
| | 6 | 000101 21300 | PUMP BODY | |
| | 9 | 020004 21300 | ROTOR | |
| | 11 | 901334 00004 | CARBON VANES (KIT) ²⁾ | |
| | 15 | 000801 21300 | LID -LEFT | |
| | 16 | 000701 21300 | LID RIGHT | |
| | 17 | 025512 21300 | GASKET | |
| | 18 | 001101 21300 | BEARING COVER | |
| | 19 | 001006 21300 | BEARING COVER | |
| | 20 | 025513 21300 | GASKET | |
| | 24 | 911305 00000 | SEAL | |
| | 25 | 917159 00000 | COMPENSATING DISC | |
| | 26 | 906544 00000 | SHAFT-SEALING RING | |
| | 27 | 906621 00000 | BALL BEARING | |
| | 28 | 906664 00000 | BALL BEARING | |
| | 30 | 511400 10400 | SET DISTANCE DISC | |
| | 38 | 016801 21300 | CLAMPING DISC | |
| | 39 | 949807 00000 | SCREW | |
| | 41 | 945224 00000 | HEX-HEAD SCREW | |
| | 42 | 945218 00000 | HEX-HEAD SCREW | |
| | 43 | 901804 00000 | HEX-HEAD SCREW | |
| | 45 | 948742 00000 | STRAIGHT PIN | |
| | 47 | 947736 00000 | KEY | |
| | 50 | 053201 21300 | CONNECTION FLANGE | |
| | 52 | 950308 00000 | WASHER | |
| | 53 | 945331 00000 | SOCKET HEAD SCREW | |
| | 56 | 544501 21300 | COUPLING WITH FAN | |
| | 57 | 949409 00000 | WASHER | |
| | 58 | 945270 00000 | SHAFT END BOLD | |
| | 61 | 040102 21300 | FILTER HOUSING | |
| | 62 | 025501 21300 | GASKET | |
| | 64 | 951009 00000 | STUD | |
| | 65 | 951003 00000 | STUD | |
| | 67 | 964407 00000 | SILENCER TUBE | |
| | 68 | 909507 00000 | FILTER CARTRIDGE C 1112/2 (2x) ²⁾ | |
| | 71 | 009000 27000 | LEAF SPRING | |
| | 72 | 948750 00000 | BLIND RIVET | |
| | 73 | 040204 21300 | FILTER COVER | |
| | 75 | 025518 21300 | GASKET | |
| | 76 | 025516 21100 | GASKET | |
| | 77 | 022802 21100 | FILTER HOLDER | |
| | 79 | 945320 00000 | SOCKET HEAD SCREW | |
| | 81 | 947504 00000 | WASHER | |
| | 83 | 952019 00000 | LOCATING PEG | |
| | 91 | 909514 00000 | FILTER CARTRIDGE C 718 (1x) ²⁾ | |
| | 93 | 903800 70000 | STUD | |
| | 94 | 947105 00000 | HEX.NUT | |
| | 95 | 949450 00000 | WASHER | |
| | 97 | 950304 00000 | WASHER | |
| | 98 | 945321 00000 | SOCKET HEAD SCREW | |
| | 103 | 068801 21300 | DUST SEPARATOR COVER | |
| | 104 | 025515 21300 | GASKET | |
| | 110 | 921500 50000 | HANDLE | |
| | 121 | 560204 21300 | COOLER | |
| | 122 | 025506 21300 | GASKET | |
| | 123 | 066802 21300 | PRESSURE CONNECTION BOX | |
| | 125 | 025504 21300 | GASKET | |
| | 126 | 025514 21300 | GASKET | |
| | 131 | 948021 00000 | SEALING RING | |

| D INDEX | Pos. | Ident No. | Description |  |
|------------|------|--|--|--|
| | 132 | 945374 00000 | SOCKET HEAD SCREW | |
| | 137 | 945322 00000 | SOCKET HEAD SCREW | |
| | 142 | 016605 21300 | CONNECTING PIECE | |
| | 146 | 025507 21300 | GASKET | |
| | 148 | 945364 00000 | SOCKET HEAD SCREW | |
| | 149 | 741310 30000 | RUBBER BUFFER | |
| | 161 | 918300 21300 | COVERING HOOD | |
| | 163 | 920800 21300 | AIR GUIDE HOOD | |
| | 165 | 960700 21300 | VENTILATOR HOOD | |
| | 166 | 960701 21300 | VENTILATOR HOOD | |
| | 171 | 945371 00000 | SOCKET HEAD SCREW | |
| | 172 | 945372 00000 | SOCKET HEAD SCREW | |
| | 173 | 949806 00000 | SCREW | |
| | 174 | 951703 00000 | SPRING DISC | |
| | 176 | 741302 00000 | RUBBER BUFFER | |
| | 177 | 945634 00000 | THREADED PIN | |
| | 178 | 948802 00000 | RING SCREW | |
| | 181 | 014902 21300 | FLANGE | |
| | 184 | 951916 00000 | RUBBER BUSHING | |
| | 185 | 948772 00000 | PIPE RIVET | |
| | 186 | 947508 00000 | WASHER | |
| | 188 | 945335 00000 | SOCKET HEAD SCREW | |
| | 190 | 951018 00000 | STUD | |
| | 192 | 947506 00000 | WASHER | |
| | 193 | 947106 00000 | HEX.NUT | |
| | 197 | 902108 00000 | COUPLING | |
| | 199 | 902210 00000 | COUPLING DISC | |
| | 241 | 012200 21300 | OIL-PIPE | |
| | 244 | 912300 00000 | CONNECTING SCREW | |
| | 245 | 009400 19000 | HOLLOW HOLDING SCREW | |
| | 247 | 948074 00000 | SEALING RING | |
| | 250 | 949002 00000 | GREASE NIPPLE | |
| | 342 | 736001 99624 | VACUUM REGULATING VALVE | |
| | 356 | 727510 99323 | BLOW-OFF VALVE | |
| | |  743303 00000 | GREASE, AMBLYGON TA15/2 (GREASE PRESS, 50g) | |

¹⁾ Set of seals - 54900021300 - Pos.: 17, 20, 24, 62, 75, 76, 86, 104, 122, 125, 126, 146
²⁾ necessary order quantity / maintenance

| D INDICE | Pos. | No. Identification | Designation | FR | |
|-------------|--------------|--|---|----|--|
| | | | | | |
| KVT 3.140 | □ | 549000 21300 | JEU DE JOINTS ¹⁾ | | |
| | 6 | 000101 21300 | CORP DE POMPE | | |
| | 9 | 020004 21300 | PISTON | | |
| | 11 | 901334 00004 | PALETTE DE CHARBON (KIT) ²⁾ | | |
| | 15 | 000801 21300 | COUVERCLE A GAUCHE | | |
| | 16 | 000701 21300 | COUVERCLE A DROITE | | |
| | 17 | 025512 21300 | JOINT | | |
| | 18 | 001101 21300 | COUVERCLE DE ROULEMENTE | | |
| | 19 | 001006 21300 | COUVERCLE DE ROULEMENTE | | |
| | 20 | 025513 21300 | JOINT | | |
| | 24 | 911305 00000 | JOINT | | |
| | 25 | 917159 00000 | DISQUE DE COMPENSATION | | |
| | 26 | 906544 00000 | BAGUE D'ETANCHEITE P.L'AXE | | |
| 27 | 906621 00000 | ROULEMENT A BILLES | | | |
| 28 | 906664 00000 | ROULEMENT A BILLES | | | |
| 30 | 511400 10400 | JEU DISQUE DE TOLERANCE | | | |
| 38 | 016801 21300 | DISQUE DE SERRAGE | | | |
| 39 | 949807 00000 | VIS | | | |
| 41 | 945224 00000 | VIS HEXAGONALE | | | |
| 42 | 945218 00000 | VIS HEXAGONALE | | | |
| 43 | 901804 00000 | VIS HEXAGONALE | | | |
| 45 | 948742 00000 | GOUPILLE CYLINDRIQUE | | | |
| 47 | 947736 00000 | CLAVETTE | | | |
| 50 | 053201 21300 | BRIDE DE RACCORDEMENT | | | |
| 52 | 950308 00000 | RONDELLE | | | |
| 53 | 945331 00000 | VIS HEXAGONALE INTERNE | | | |
| 56 | 544501 21300 | ACCOUPLLEMENT AVEC VENTILATEUR | | | |
| 57 | 949409 00000 | RONDELLE | | | |
| 58 | 945270 00000 | VIS BOUT D'ARBRE | | | |
| 61 | 040102 21300 | BOITE POUR FILTRE | | | |
| 62 | 025501 21300 | JOINT | | | |
| 64 | 951009 00000 | PRISONNIER | | | |
| 65 | 951003 00000 | PRISONNIER | | | |
| 67 | 964407 00000 | TUBE SILENCIEUX | | | |
| 68 | 909507 00000 | CARTOUCHE FILTRANTE C 1112/2 (2x) ²⁾ | | | |
| 71 | 009000 27000 | RESSORT-JAME | | | |
| 72 | 948750 00000 | RIVET AVEUGLIE | | | |
| 73 | 040204 21300 | COUVERCLE DE FILTRE | | | |
| 75 | 025518 21300 | JOINT | | | |
| 76 | 025516 21100 | JOINT | | | |
| 77 | 022802 21100 | SUPPORT FILTRE | | | |
| 79 | 945320 00000 | VIS HEXAGONALE INTERNE | | | |
| 81 | 947504 00000 | RONDELLE | | | |
| 83 | 952019 00000 | DOUILLE DE ETRAGE | | | |
| 91 | 909514 00000 | CARTOUCHE FILTRANTE C 718 (1x) ²⁾ | | | |
| 93 | 903800 70000 | PRISONNIER | | | |
| 94 | 947105 00000 | ECROU A 6 PANS | | | |
| 95 | 949450 00000 | RONDELLE | | | |
| 97 | 950304 00000 | RONDELLE | | | |
| 98 | 945321 00000 | VIS HEXAGONALE INTERNE | | | |
| 103 | 068801 21300 | COUVERCLE | | | |
| 104 | 025515 21300 | JOINT | | | |
| 110 | 921500 50000 | POIGNEE | | | |
| 121 | 560204 21300 | REFROIDISSEUR | | | |
| 122 | 025506 21300 | JOINT | | | |
| 123 | 066802 21300 | BOITIER DE RACCORD DE REFOULEMENT | | | |
| 125 | 025504 21300 | JOINT | | | |
| 126 | 025514 21300 | JOINT | | | |
| 131 | 948021 00000 | JOINT | | | |

| D INDICE | Pos. | No. Identification | Designation | FR | |
|-------------|------|--------------------|--|----|--|
| | | | | | |
| | 132 | 945374 00000 | VIS HEXAGONALE INTERNE | | |
| | 137 | 945322 00000 | VIS HEXAGONALE INTERNE | | |
| | 142 | 016605 21300 | PIECE RACCORD | | |
| | 146 | 025507 21300 | JOINT | | |
| | 148 | 945364 00000 | VIS HEXAGONALE INTERNE | | |
| | 149 | 741310 30000 | AMORTISSEUR EN CAOUTCHOUC | | |
| | 161 | 918300 21300 | CARTER | | |
| | 163 | 920800 21300 | CAPOT DE CANALISATION DE L'AIR | | |
| | 165 | 960700 21300 | CARTER DE VENTILATEUR | | |
| | 166 | 960701 21300 | CARTER DE VENTILATEUR | | |
| | 171 | 945371 00000 | VIS HEXAGONALE INTERNE | | |
| | 172 | 945372 00000 | VIS HEXAGONALE INTERNE | | |
| | 173 | 949806 00000 | VIS A TÊTE NOYÉE | | |
| | 174 | 951703 00000 | DISQUE DE RESSORT | | |
| | 176 | 741302 00000 | AMORTISSEUR EN CAOUTCHOUC | | |
| | 177 | 945634 00000 | GOUPILLE FILETEE | | |
| | 178 | 948802 00000 | PITON | | |
| | 181 | 014902 21300 | BRIDE | | |
| | 184 | 951916 00000 | PROTECTION EN CAOUTCHOUC | | |
| | 185 | 948772 00000 | RIVET TUBE | | |
| | 186 | 947508 00000 | RONDELLE | | |
| | 188 | 945335 00000 | VIS HEXAGONALE INTERNE | | |
| | 190 | 951018 00000 | PRISONNIER | | |
| | 192 | 947506 00000 | RONDELLE | | |
| | 193 | 947106 00000 | ECROU A 6 PANS | | |
| | 197 | 902108 00000 | ACCOUPLLEMENT | | |
| | 199 | 902210 00000 | DISQUE D'ACCOUPLLEMENT | | |
| | 241 | 012200 21300 | TUYEAU DE GRAISSAGE | | |
| | 244 | 912300 00000 | VIS DE RACCORD | | |
| | 245 | 009400 19000 | VIS CREUSE DE FIXATION | | |
| | 247 | 948074 00000 | JOINT | | |
| | 250 | 949002 00000 | GRAISSEUR | | |
| | 342 | 736001 99624 | SOUPAPE REGULAGE VIDE | | |
| | 356 | 727510 99323 | SOUPAPE D'ÉCHAPPEMENT | | |
| | | 743303 00000 | GRAISSE, AMBLYGON TA15/2 (POMPE À GRAISSE, 50g) | | |

¹⁾ Jeu de joints - 54900021300 - Pos.: 17, 20, 24, 62, 75, 76, 86, 104, 122, 125, 126, 146

²⁾ quantité nécessaire / entretien

| D INDICE | Pos. | No. Identificazione | Designazione |
|-------------|--------------|---|--|
| KVT 3.140 | □ | 549000 21300 | SERIE DI GUARNIZIONE ¹⁾ |
| | 6 | 000101 21300 | CARASSA |
| | 9 | 020004 21300 | ROTORE |
| | 11 | 901334 00004 | PALETTE DI CHARBONE (KIT) ²⁾ |
| | 15 | 000801 21300 | COPERCHIO SINISTRA |
| | 16 | 000701 21300 | COPERCHIO DESTRA |
| | 17 | 025512 21300 | GUARNIZIONE |
| | 18 | 001101 21300 | COPERCHIO CUSCINETTO |
| | 19 | 001006 21300 | COPERCHIO CUSCINETTO |
| | 20 | 025513 21300 | GUARNIZIONE |
| | 24 | 911305 00000 | GUARNIZIONE |
| | 25 | 917159 00000 | DISCO COMPENSATORE |
| | 26 | 906544 00000 | GUARNIZIONE PER L'ALBERO |
| 27 | 906621 00000 | CUSCINETTO A SFERA | |
| 28 | 906664 00000 | CUSCINETTO A SFERA | |
| 30 | 511400 10400 | SERIE DISCO GIUOCO | |
| 38 | 016801 21300 | DISCO DI FISSAGIO | |
| 39 | 949807 00000 | VITE | |
| 41 | 945224 00000 | VITE ESAGONALE | |
| 42 | 945218 00000 | VITE ESAGONALE | |
| 43 | 901804 00000 | VITE ESAGONALE | |
| 45 | 948742 00000 | PERNO | |
| 47 | 947736 00000 | CHIAVETTA | |
| 50 | 053201 21300 | FLANGIA DI RACCORDE | |
| 52 | 950308 00000 | RONDELLA | |
| 53 | 945331 00000 | VITE ESAGONALE INTERNA | |
| 56 | 544501 21300 | GIUNTO CON VENTILATORE | |
| 57 | 949409 00000 | RONDELLA | |
| 58 | 945270 00000 | VITE DI CHIUSURA ALBERO | |
| 61 | 040102 21300 | CONTENITORE FILTRO | |
| 62 | 025501 21300 | GUARNIZIONE | |
| 64 | 951009 00000 | L'ASTA A VITE | |
| 65 | 951003 00000 | L'ASTA A VITE | |
| 67 | 964407 00000 | TUBO SILENZIATORE | |
| 68 | 909507 00000 | CARTUCCIA FILTRO C 1112/2 (2x) ²⁾ | |
| 71 | 009000 27000 | MOLLA | |
| 72 | 948750 00000 | RIVETTO CIECO | |
| 73 | 040204 21300 | COPERCHIO FILTRO | |
| 75 | 025518 21300 | GUARNIZIONE | |
| 76 | 025516 21100 | GUARNIZIONE | |
| 77 | 022802 21100 | SUPPORTO FILTRO | |
| 79 | 945320 00000 | VITE ESAGONALE INTERNA | |
| 81 | 947504 00000 | RONDELLA | |
| 83 | 952019 00000 | SPINE DI RISCONTRO | |
| 91 | 909514 00000 | CARTUCCIA FILTRO C 718 (1x) ²⁾ | |
| 93 | 903800 70000 | L'ASTA A VITE | |
| 94 | 947105 00000 | DADO ESAGONALE | |
| 95 | 949450 00000 | RONDELLA | |
| 97 | 950304 00000 | RONDELLA | |
| 98 | 945321 00000 | VITE ESAGONALE INTERNA | |
| 103 | 068801 21300 | COPERCHIO | |
| 104 | 025515 21300 | GUARNIZIONI | |
| 110 | 921500 50000 | MANETTA | |
| 121 | 560204 21300 | RAFFREDDATORE | |
| 122 | 025506 21300 | GUARNIZIONE | |
| 123 | 066802 21300 | SCATOLA DI RACCORDO DI MANDATA | |
| 125 | 025504 21300 | GUARNIZIONE | |
| 126 | 025514 21300 | GUARNIZIONI | |
| 131 | 948021 00000 | ANELLO GUARNIZIONE | |

| D INDICE | Pos. | No. Identificazione | Designazione |
|-------------|------|---------------------|---|
| | 132 | 945374 00000 | VITE ESAGONALE INTERNA |
| | 137 | 945322 00000 | VITE ESAGONALE INTERNA |
| | 142 | 016605 21300 | PEZZI RACCORDI |
| | 146 | 025507 21300 | GUARNIZIONE |
| | 148 | 945364 00000 | VITE ESAGONALE INTERNA |
| | 149 | 741310 30000 | AMMORTIZZATORE IN GOMMA |
| | 161 | 918300 21300 | CARTER |
| | 163 | 920800 21300 | CAPPOTTA DEL CONDOTTA ARIA |
| | 165 | 960700 21300 | CARTER VENTILATORE |
| | 166 | 960701 21300 | CARTER VENTILATORE |
| | 171 | 945371 00000 | VITE ESAGONALE INTERNA |
| | 172 | 945372 00000 | VITE ESAGONALE INTERNA |
| | 173 | 949806 00000 | VITE A TESTA SVASATA |
| | 174 | 951703 00000 | DISCO A MOLLA |
| | 176 | 741302 00000 | AMMORTIZZATORE IN GOMMA |
| | 177 | 945634 00000 | SPINA FILETTATURA |
| | 178 | 948802 00000 | GANCIO |
| | 181 | 014902 21300 | FLANGIA |
| | 184 | 951916 00000 | PROTEZIONE IN GOMMA |
| | 185 | 948772 00000 | CHiodo TUBOLARE |
| | 186 | 947508 00000 | RONDELLA |
| | 188 | 945335 00000 | VITE ESAGONALE INTERNA |
| | 190 | 951018 00000 | L'ASTA VITE |
| | 192 | 947506 00000 | RONDELLA |
| | 193 | 947106 00000 | DADO ESAGONALE |
| | 197 | 902108 00000 | GIUNTO |
| | 199 | 902210 00000 | DISCO GIUNTO |
| | 241 | 012200 21300 | CONDOTTO |
| | 244 | 912300 00000 | ATTACO FILETTATO |
| | 245 | 009400 19000 | VITE PASSAGGIO OLIO |
| | 247 | 948074 00000 | ANELLO GUARNIZIONE |
| | 250 | 949002 00000 | RACCORDO DI LUBRIFICAZIONE |
| | 342 | 736001 99624 | VALVOLA REGOLAZIONE VUOTO |
| | 356 | 727510 99323 | VALVOLA DI SFIATO |
| | | 743303 00000 | GRASSO, AMBYGON TA15/2 (INGRASSATORE A PISTOLA, 50g) |

¹⁾ Serie di guarnizione - 54900021300 - Pos.: 17, 20, 24, 62, 75, 76, 86, 104, 122, 125, 126, 146

²⁾ quantità di ordinazione necessari / manutenzione

| D INDICE | Pos. | No. De pedido | Descripción |  |
|-------------|------|---------------|---|---|
| KVT 3.140 | □ | 549000 21300 | JUNTA COMPLETA ¹⁾ | |
| | 6 | 000101 21300 | CARCASA | |
| | 9 | 020004 21300 | ÉMBOLO, ACABADO | |
| | 11 | 901334 00004 | EMPUJADOR (KIT) ²⁾ | |
| | 15 | 000801 21300 | TAPA LATERAL | |
| | 16 | 000701 21300 | TAPA LATERAL DERECHA | |
| | 17 | 025512 21300 | JUNTA | |
| | 18 | 001101 21300 | TAPA DE COJINETE | |
| | 19 | 001006 21300 | TAPA DE COJINETE | |
| | 20 | 025513 21300 | JUNTA | |
| | 24 | 911305 00000 | MANGUERA DE JUNTA | |
| | 25 | 917159 00000 | ARANDELA DE COMPENSACIÓN | |
| | 26 | 906544 00000 | ANILLO DE JUNTA DE ÁRBOL | |
| | 27 | 906621 00000 | COJINETE DE RODAMIENTO | |
| | 28 | 906664 00000 | COJINETE DE RODAMIENTO NU 206/ZS | |
| | 30 | 511400 10400 | JUEGO DE ARANDELAS DISTANCIADORAS | |
| | 38 | 016801 21300 | ARANDELA TENSORA | |
| | 39 | 949807 00000 | TORNILLO AVELLANADO | |
| | 41 | 945224 00000 | TORNILLO DE CABEZA HEXAGONAL | |
| | 42 | 945218 00000 | TORNILLO DE CABEZA HEXAGONAL | |
| | 43 | 901804 00000 | TORNILLO DE CABEZA HEXAGONAL | |
| | 45 | 948742 00000 | PASADOR ENTALLADO DE AJUSTE | |
| | 47 | 947736 00000 | LENGÜETA DE AJUSTE | |
| | 50 | 053201 21300 | FAROL | |
| | 52 | 950308 00000 | ARANDELA | |
| | 53 | 945331 00000 | TORNILLO HEXAGONAL INTERIOR | |
| | 56 | 544501 21300 | MITAD DE ACOPLAMIENTO CON VENTILADOR | |
| | 57 | 949409 00000 | ARANDELA | |
| | 58 | 945270 00000 | TORNILLO TERMINAL DE ÁRBOL | |
| | 61 | 040102 21300 | CARCASA DE FILTRO | |
| | 62 | 025501 21300 | JUNTA | |
| | 64 | 951009 00000 | ESPÁRRAGO | |
| | 65 | 951003 00000 | ESPÁRRAGO | |
| | 67 | 964407 00000 | TUBO DE SILENCIADOR | |
| | 68 | 909507 00000 | CARTUCHO DE FILTRO C 1112/2 (2x) ²⁾ | |
| | 71 | 009000 27000 | MUELLE DE PRESIÓN | |
| | 72 | 948750 00000 | REMACHE CIEGO | |
| | 73 | 040204 21300 | TAPA DE FILTRO | |
| | 75 | 025518 21300 | JUNTA | |
| | 76 | 025516 21100 | JUNTA | |
| | 77 | 022802 21100 | SOPORTE DE FILTRO | |
| | 79 | 945320 00000 | TORNILLO HEXAGONAL INTERIOR | |
| | 81 | 947504 00000 | ARANDELA | |
| | 83 | 952019 00000 | CASQUILLO TENSOR | |
| | 91 | 909514 00000 | CARTUCHO DE FILTRO C 718 (1x) ²⁾ | |
| | 93 | 903800 70000 | ESPÁRRAGO | |
| | 94 | 947105 00000 | TUERCA HEXAGONAL | |
| | 95 | 949450 00000 | ARANDELA | |
| | 97 | 950304 00000 | ARANDELA | |
| | 98 | 945321 00000 | TORNILLO HEXAGONAL INTERIOR | |
| | 103 | 068801 21300 | TAPA DE SEPARADOR DE POLVO | |
| | 104 | 025515 21300 | JUNTA | |
| | 110 | 921500 50000 | EMPUÑADURA | |
| | 121 | 560204 21300 | REFRIGERADOR | |
| | 122 | 025506 21300 | JUNTA | |
| | 123 | 066802 21300 | CAJA DE EMPALME DE PRESIÓN | |
| | 125 | 025504 21300 | JUNTA | |
| | 126 | 025514 21300 | JUNTA | |
| | 131 | 948021 00000 | ANILLO DE JUNTA | |







| D INDICE | Pos. | No. De pedido | Descripción |  |
|-------------|------|---------------|---|--|
| | 132 | 945374 00000 | TORNILLO HEXAGONAL INTERIOR | |
| | 137 | 945322 00000 | TORNILLO HEXAGONAL INTERIOR | |
| | 142 | 016605 21300 | PIEZA DE EMPALME | |
| | 146 | 025507 21300 | JUNTA | |
| | 148 | 945364 00000 | TORNILLO HEXAGONAL INTERIOR | |
| | 149 | 741310 30000 | AMORTIGUADOR DE GOMA | |
| | 161 | 918300 21300 | CAPERUZA DE RECUBRIMIENTO | |
| | 163 | 920800 21300 | CAPERUZA CONDUCTOR DE AIRE | |
| | 165 | 960700 21300 | CAPERUZA DE VENTILADOR | |
| | 166 | 960701 21300 | CAPERUZA DE VENTILADOR | |
| | 171 | 945371 00000 | TORNILLO HEXAGONAL INTERIOR | |
| | 172 | 945372 00000 | TORNILLO HEXAGONAL INTERIOR | |
| | 173 | 949806 00000 | TORNILLO AVELLANADO | |
| | 174 | 951703 00000 | ARANDELA ELÁSTICA | |
| | 176 | 741302 00000 | AMORTIGUADOR DE GOMA | |
| | 177 | 945634 00000 | VARILLA ROSCADA | |
| | 178 | 948802 00000 | TORNILLO DE CÁNCAMO | |
| | 181 | 014902 21300 | BRIDA INTERMEDIA | |
| | 184 | 951916 00000 | BOQUILLA DE CABLE | |
| | 185 | 948772 00000 | REMACHE TUBULAR | |
| | 186 | 947508 00000 | ARANDELA | |
| | 188 | 945335 00000 | TORNILLO HEXAGONAL INTERIOR | |
| | 190 | 951018 00000 | ESPÁRRAGO | |
| | 192 | 947506 00000 | ARANDELA | |
| | 193 | 947106 00000 | TUERCA HEXAGONAL | |
| | 197 | 902108 00000 | MITAD DE ACOPLAMIENTO (MOT) | |
| | 199 | 902210 00000 | DISCO DE ACOPLAMIENTO | |
| | 241 | 012200 21300 | CONDUCTO | |
| | 244 | 912300 00000 | TORNILLO DE EMPALME | |
| | 245 | 009400 19000 | TORNILLO DE PIEZA ESFÉRICA | |
| | 247 | 948074 00000 | ANILLO DE JUNTA | |
| | 250 | 949002 00000 | BOQUILLA DE TOLVA DE LUBRICACIÓN | |
| | 342 | 736001 99624 | VÁLVULA REGULADORA DE VACÍO | |
| | 356 | 727510 99323 | VÁLVULA DE ESCAPE | |
| | | 743303 00000 | GRASA, AMBLYGON TA15/2 (PISTOLA DE GRASA, 50g) | |

¹⁾ Junta completa - 54900021300 - Pos.: 17, 20, 24, 62, 75, 76, 86, 104, 122, 125, 126, 146

²⁾ cantidad necesario / mantenimiento

| KVT 3.140 | Variante | Pos. ²⁾ | Bestell Nr. / Ident No. / No. Identification / No. Identificazione / No. De pedido | | Beschreibung / Description / Designation / Designazione / Desripcion | |
|---|--------------|--------------------|--|--------------|--|--|
| | | | | | | |
| ① US-motor | | 181 | | 014902-21300 | ZWISCHENFLANSCH / FLANGE / BRIDE / FLANGIA / BRIDA INTERMEDIA | |
| | | 197 | | 902108-00000 | KUPPLUNGSHÄLFTE / COUPLING / ACCOUPLEMENT / GIUNTO / MITAD DE ACOPLAMIENTO | |
| | | 233 | 014903 21300 | | | (B5 - 300) ZWISCHENFLANSCH / FLANGE / BRIDE / FLANGIA / BRIDA INTERMEDIA |
| | | 234 | 037900 10400 | | | (B5 - 250) ZWISCHENFLANSCH / FLANGE / BRIDE / FLANGIA / BRIDA INTERMEDIA |
| | | 235 | 902100 21300 | | | KUPPLUNGSHÄLFTE / COUPLING / ACCOUPLEMENT / GIUNTO / MITAD DE ACOPLAMIENTO |
| ② /6 - Korrosionsschutz - corrosion protection - protection contre la corrosion - protezione anti-corrosione - protección contra la corrosión | | 6 | 000111 21300 | 000101-21300 | GEHÄUSE / PUMP BODY / CORP DE POMPE / CARCASSA / CARCASA | |
| | | 9 | 020011 21300 | 020005-21300 | KOLBEN / ROTOR / PISTON / ROTORE / ÉMBOLO | |
| | | 11 | 901381 00004 | 901334-00004 | SATZ (KIT) SCHIEBER / VANES / PALETTE / PALETTE / EMPUJADOR | |
| | | 15 | 000811 21300 | 000803-21300 | SEITENDECKEL / LID LATERAL / COUVERCLE LATÉRAL / COPERCHIO LATERALE / TAPA LATERAL | |
| | | 16 | 000711 21300 | 000701-21300 | SEITENDECKEL / LID LATERAL / COUVERCLE LATÉRAL / COPERCHIO LATERALE / TAPA LATERAL | |
| | | 68 | | 909507-00000 | (1x) FILTERPATRONE / FILTER CARTRIDGE / CARTOUCHE FILTRE / CARTUCCIA FILTRO / CARTUCHO DE FILTRO | |
| | | 69 | 909587 00000 | | (1x POLYESTER) FILTERPATRONE / FILTER CARTRIDGE / CARTOUCHE FILTRE / CARTUCCIA FILTRO / CARTUCHO DE FILTRO | |
| ③+④ /6-54 + /6-59 - Korrosionsschutz - corrosion protection - protection contre la corrosion - protezione anti-corrosione - protección contra la corrosión | | 6 | 000111 21300 | 000101-21300 | GEHÄUSE / PUMP BODY / CORP DE POMPE / CARCASSA / CARCASA | |
| | | 9 | 020011 21300 | 020005-21300 | KOLBEN / ROTOR / PISTON / ROTORE / ÉMBOLO | |
| | | 11 | 901381 00004 | 901334-00004 | SATZ (KIT) SCHIEBER / VANES / PALETTE / PALETTE / EMPUJADOR | |
| | | 15 | 000811 21300 | 000803-21300 | SEITENDECKEL / LID LATERAL / COUVERCLE LATÉRAL / COPERCHIO LATERALE / TAPA LATERAL | |
| | | 16 | 000711 21300 | 000701-21300 | SEITENDECKEL / LID LATERAL / COUVERCLE LATÉRAL / COPERCHIO LATERALE / TAPA LATERAL | |
| | | 68 | | 909507-00000 | (1x) FILTERPATRONE / FILTER CARTRIDGE / CARTOUCHE FILTRE / CARTUCCIA FILTRO / CARTUCHO DE FILTRO | |
| | | 69 | 909587 00000 | | (1x POLYESTER) FILTERPATRONE / FILTER CARTRIDGE / CARTOUCHE FILTRE / CARTUCCIA FILTRO / CARTUCHO DE FILTRO | |
| | | 76 | | 02551621100 | DICHTUNG / GASKET / JOINT / GUARNIZIONE / JUNTA | |
| | | 77 | | 02280221100 | FILTERTRÄGER / FILTER HOLDER / SUPPORT FILTRE / SUPPORTO FILTRO / SOPORTE DE FILTRO | |
| | | 79 | 945321 00000 | 945320-00000 | INNENSECHSKANTSCHRAUBE / SOCKET HEAD SCREW / VIS HEXAGONALE INTERNE / VITE ESAGONALE INTERNA / TORNILLO HEXAGONAL INTERIOR | |
| | | 80 | 946944 00000 | | STIFTSCHRAUBE / STUD / PRISONNIER / L'ASTA A VITE / ESPÁRRAGO | |
| | | 82 | 947104 00000 | | SECHSKANTMUTTER / HEX.NUT / ECROU A 6 PANS / DADO ESAGONALE / TUERCA HEXAGONAL | |
| | | 83 | | 95201900000 | SPANNHÜLSE / LOCATING PEG / DOUILLE DE ETRAGE / SPINE DI RISCONTRO / CASQUILLO TENSOR | |
| | | 86 | 025515 21100 | | DICHTUNG / GASKET / JOINT / GUARNIZIONE / JUNTA | |
| | | 91 | | 909514-00000 | FILTERPATRONE / FILTER CARTRIDGE / CARTOUCHE FILTRE / CARTUCCIA FILTRO / CARTUCHO DE FILTRO | |
| | | 93 | 946107 00000 | 903800-70000 | STIFTSCHRAUBE / STUD / PRISONNIER / L'ASTA A VITE / ESPÁRRAGO | |
| | | 94 | | 94710500000 | SECHSKANTMUTTER / HEX.NUT / ECROU A 6 PANS / DADO ESAGONALE / TUERCA HEXAGONAL | |
| | | 95 | | 94945000000 | UNTERLEGSCHNEIBE / WASHER / RONDELLE / RONDELLA / ARANDELA | |
| | | 141 | 016604 21300 | | ANSCHLUSSLEISTE / CONNECTING PIECE / PIECE RACCORD / PEZZI RACCORDI / PIEZA DE EMPALME | |
| | | 142 | | 016605-21300 | ANSCHLUSSLEISTE / CONNECTING PIECE / PIECE RACCORD / PEZZI RACCORDI / PIEZA DE EMPALME | |
| 230 | 019901 21100 | | UMLENKSTÜCK / RETURN PIECE / PIECE DE RETOUR / PEZZO INVERSIONE / PIEZA DE DESVIACIÓN | | | |
| 299 | 951227 00000 | | VERSCHLUSSSCHRAUBE / SCREW PLUG / BOUCHON FILETÉ / TAPPO A VITE / TAPÓN ROSCADO | | | |
| 356 | | 727510-99323 | ABBLASEVENTIL / BLOW-OFF VALVE / SOUPAPE D'ÉCHAPPEMENT / VALVOLA DI SFIATO / VÁLVULA DE ESCAPE | | | |

²⁾ variantenabhängige Bauteile / variant-dependent components / composants variante-dependantes / componenti variante-dispendenti / componentes variante-dependientes

| KVT 3.140 | Variante  | Pos. ²⁾ | Bestell Nr. / Ident No. / No. Identification / No. Identificazione / No. De pedido | | Beschreibung / Description / Designation / Designazione / Desripcion |
|---|---|--------------------|---|---|---|
| | | |    |    | |
| ⑤ /0-54 - Kühlung - refrigeration - réfrigération - refrigerazione - refrigeración | | 80 | 946944 00000 | | STIFTSCHRAUBE / STUD / TOURILLON / L'ASTA A VITE / ESPÁRRAGO |
| | | 82 | 947104 00000 | | SECHSKANTMUTTER / HEX.NUT / ECROU A 6 PANS / DADO ESAGONALE / TUERCA HEXAGONAL |
| | | 86 | 025515 21100 | | DICHTUNG / GASKET / JOINT / GUARNIZIONE / JUNTA |
| | | 141 | 016604 21300 | | ANSCHLUSS-STÜCK / CONNECTING PIECE / PIECE RACCORD / PEZZI RACCORDI / PIEZA DE EMPALME |
| | | 142 | | 016605 21300 | ANSCHLUSS-STÜCK / CONNECTING PIECE / PIECE RACCORD / PEZZI RACCORDI / PIEZA DE EMPALME |
| | | 181 | 014903 21300 | 014902 21300 | (B5 - 300) - ZWISCHENFLANSCH / FLANGE / BRIDE / FLANGIA / BRIDA INTERMEDIA |
| | | 190 | 951022 00000 | 951018 00000 | (B5 - 300) - STIFTSCHRAUBE / STUD / PRISONNIER / L'ASTA A VITE / ESPÁRRAGO |
| | | 198 | 902100 21900 | 902108 00000 | (B5 - 300) - KUPPLUNGSHÄLFTE / COUPLING / ACCOUPLEMENT / GIUNTO / MITAD DE ACOPLAMIENTO |
| | | 230 | 019901 21100 | | UMLLENKSTÜCK / RETURN PIECE / PIECE DE RETOUR / PEZZO INVERSIONE / PIEZA DE DESVIACIÓN |
| ⑥ /0-400 - mit Frequenzumrichter - with frequency convertor - avec convertisseur de fréquence - con convertitore di frequenza - protección contra la corrosión | | 401 | 796302 41115 | | FREQUENZUMFORMER / FREQUENCY CONVERTOR / CONVERTISSEUR DE FRÉQUENCE / CONVERTITORE DI FREQUENZA / CONVERTIDOR DE FRECUENCIA |

²⁾ variantenabhängige Bauteile / variant-dependent components / composants variante-dependantes / componenti variante-dispendenti / componentes variante-dependientes